



O-I Netherlands B.V.
 Spoorstraat 7
 3112 HD Schiedam, Netherlands
 Tel. +31 (0) 104094001

CONTAINER & MOULD DESIGN
EUROPE

NOTES:
 THIS DRAWING IS THE PROPERTY OF O-I AND
 MUST NOT BE REPRODUCED OR DISCLOSED
 WITHOUT O-I WRITTEN AUTHORIZATION.

DIMENSIONS EXPRESSED IN mm
 ONLY TOLERANCED DIMENSIONS ARE GUARANTEED.

MANUFACTURING MARKINGS SHOWN ARE FOR ILLUSTRATIVE
 PURPOSES ONLY, ACTUAL MARKINGS ON CONTAINER
 MAY DIFFER, DEPENDANT ON LOCAL LEGISLATION.

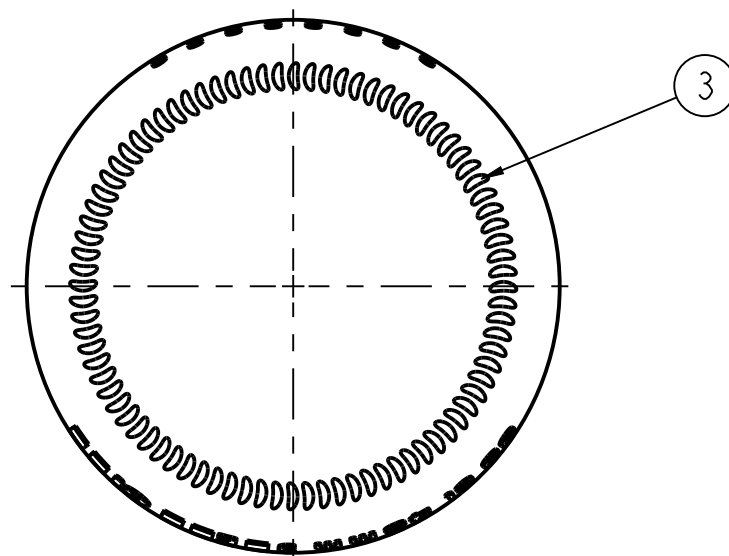
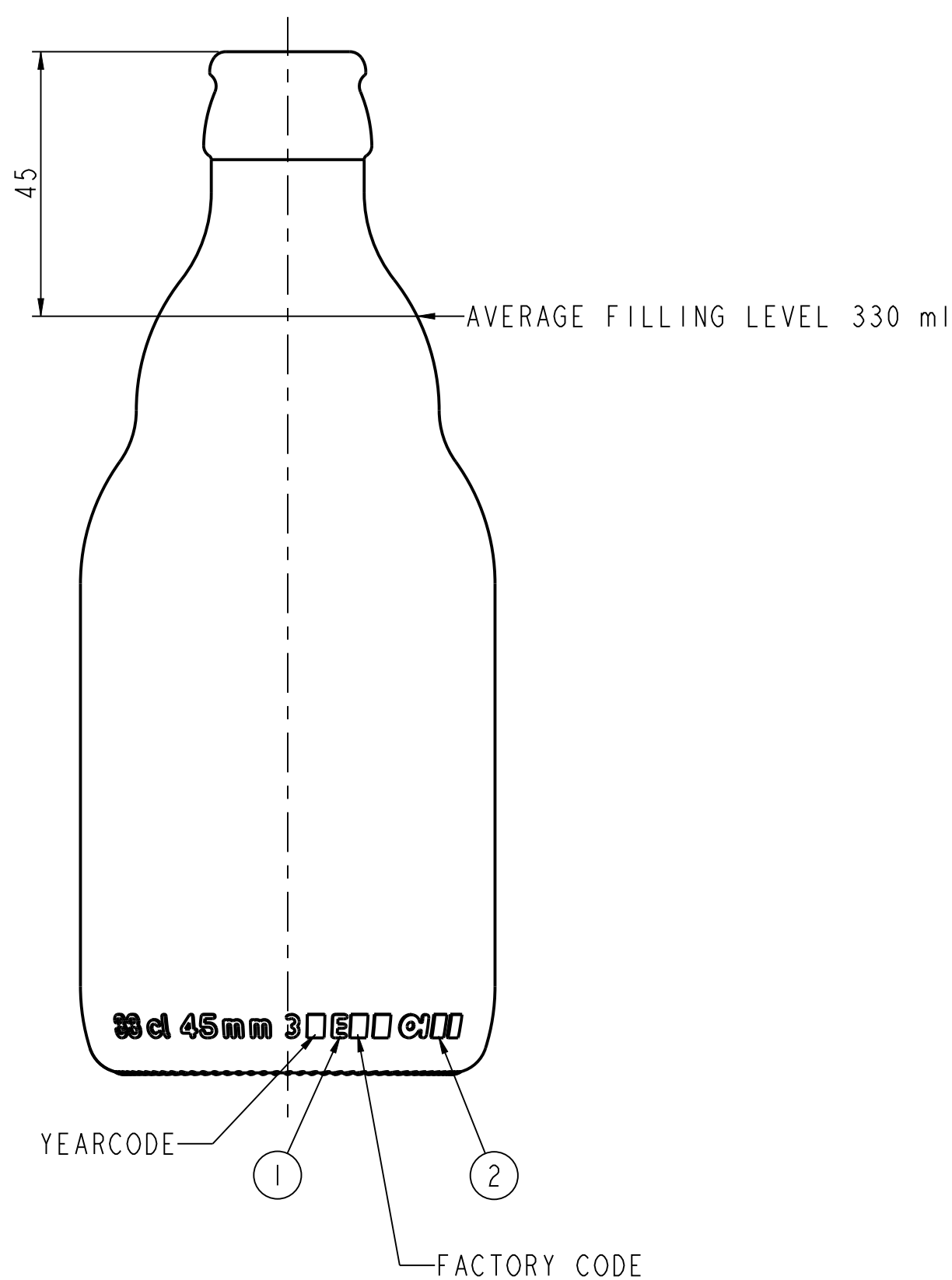
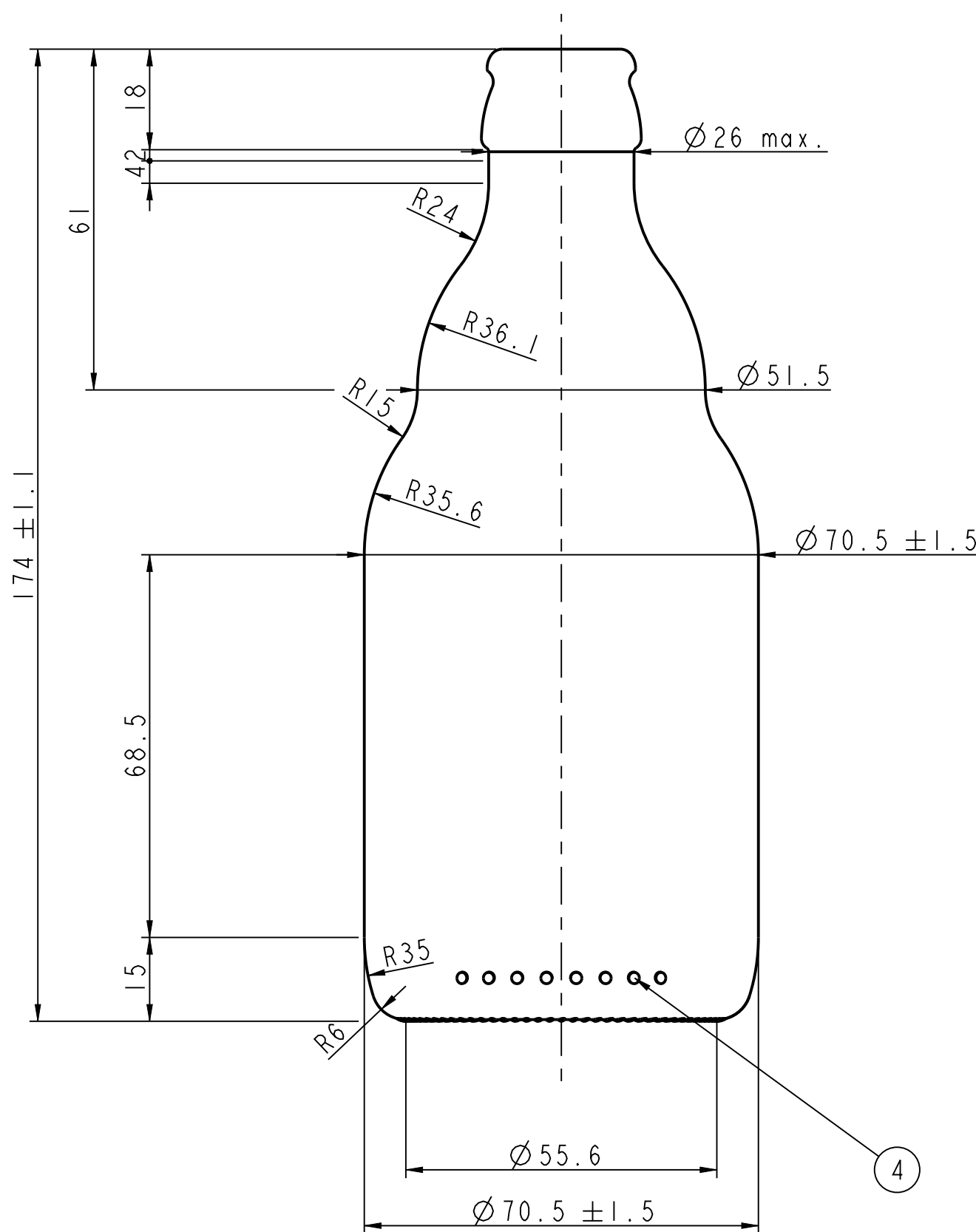
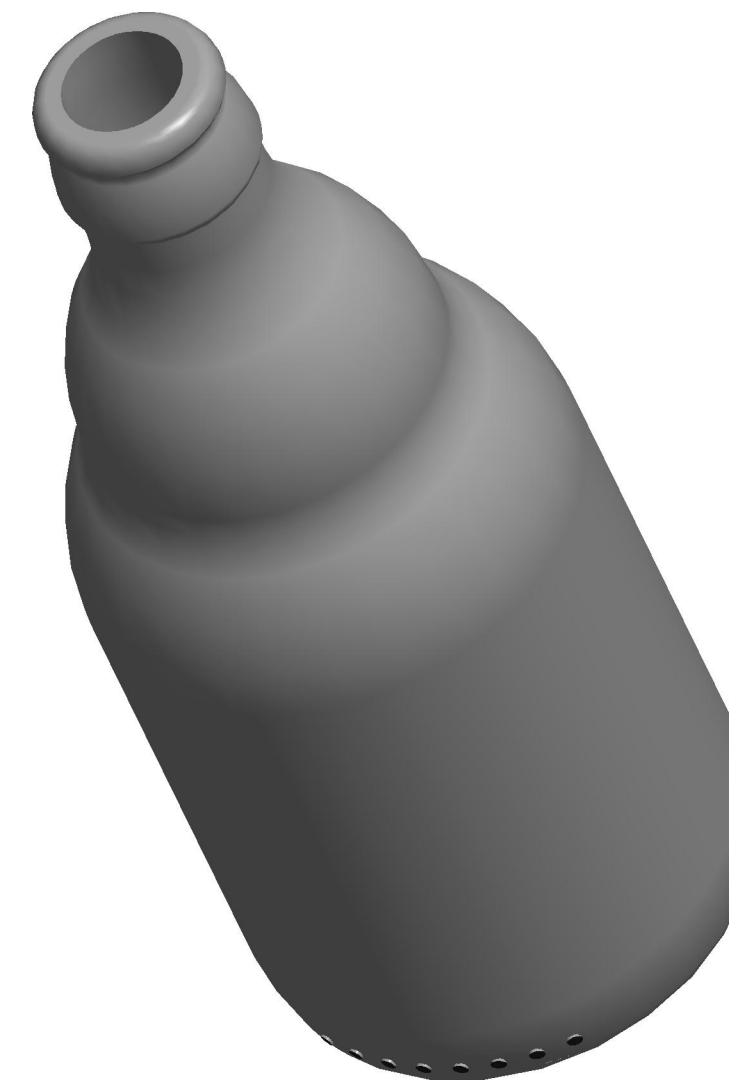

1 = TRADEMARK
 2 = CAVITY No.
 3 = STIPPLING
 THE SHAPE OF STIPPLES IS ONLY AN
 INDICATION AND THE CONSTRUCTION IS AT
 THE PRODUCTION PLANT DISCRETION.
 4 = CAVITY CODE

SCALE 1:1

CATEGORY BEER	TILT ANGLE 25.13°	
MAX. VERTICALITY TOLERANCE 2.0 mm	MEASURING CONTAINER YES	
FINISH SAP NUMBER 0586	FINISH REF. DIN 6094 / 1 - A - 26 1995	
MINIMUM THROUGH BORE 16.0 mm	MAX FILLING TUBE Ø 15 mm	
CONTAINER OVERFLOW CAPACITY (BRIMFUL)		
345ml ± 6,6ml		
CONTAINER RATED CAPACITY (FILLPOINT)		
330ml ± 6,6ml		
CONTAINER WEIGHT		
303g APPROX.		
FINISH DESIGNATION NL_26_DIN 6094 / 1_H180_0586	MAX GAS VOLUME	
PROCESS	RETURNABLE	DESIGN REF.
	YES	

33 cl STEINI III RB

DESIGNER	WGAD	DATE	17-03-2009
CHECKED	RAV	DATE	17-03-2009

DRAWING NUMBER
080224

SHAPE NUMBER
004732

No	DATE	REVISIONS	DESIGN/CHECK
3	07-07-20	DRAWING UPDATED FOR KBE	R.Ho
2	06-02-11	FINISH CHANGED	RAV
1	12-04-10	CHANGED SAP-CODE	RAV